



codrone MINI Manual

User Guide

- ① Parts List
- ② Component Name
- ③ Notes On Flight 1,2,3
- ④ Precautions
- ⑤ Ready To Fly
- ⑥ Fly Drone (Basic)
- ⑦ Fly Drone (Trim & Flip)
- ⑧ Fly Drone (Motor & Stop)
- ⑨ Mode & Sensor Reset
- ⑩ Charging & Replacement
- ⑪ Problem Solving
- ⑫ Initial Defect and Warranty

Parts List

Basic Components Guide

◆ Basic Component Guide

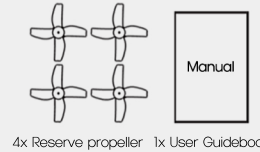

◆ Pilot guidance

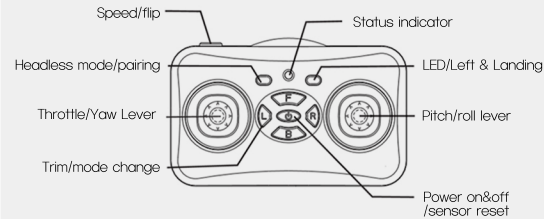

Component Name

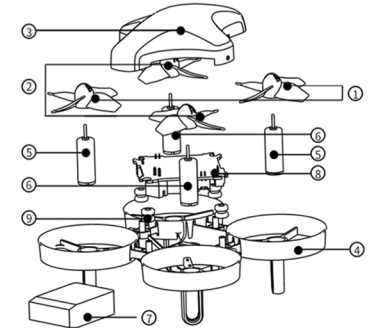

No	Name	Quantity
1	CCW Propeller (B)	2
2	CW Propeller (A)	2
3	Housing	1
4	Frame	1
5	CCW Motor	2
6	CW Motor	2
7	Lithium battery	1
8	Main board	1
9	Rubber damper	4

Notes On Flight 1

Things to Know before you fly



- (1) The product is recommended for use by users 8 years and older it is recommended that first-time users familiarize themselves with the manual and use it with sufficient practice
- (2) The drone's propellers spin very quickly and always require attention and can cause physical and property damage Always keep a distance from the drone for safety
- (3) Manufacturers and distributors are not responsible for accidents caused by inadequate operation
- (4) Fly in normal weather conditions with temperatures between 10c and 50c
- (5) Please contact the place of purchase for any inquiries about operation or repair

Notes On Flight 2

1. Always look around before your flight



2. Fly in your sight



3. Children should fly under parental supervision



4. Be Careful of using frequencies when using multiple aircraft simultaneously with other users



Notes On Flight 3



- ◆ Be sure to check all the drone regularly before flying.
- ◆ Operate after replacement and repair after damage.
- ◆ Make sure to charge using the charger provided
- ◆ Be sure to turn off the power to remove the dust
- ◆ Do not change the structure of this product arbitrarily.
- ◆ Please recycle batteries or battery packs or dispose of them correctly according to your disposal instructions.
- ◆ When storing be sure to turn off the drone and the remote controller.
- ◆ Do not throw or drop drones and controls
- ◆ Please read and understand the instruction manual.

Precautions



Do not fly drones in the following environments



◆ Near signal towers and high voltage power lines ◆ Crowded place ◆ Thunder and lightning weather



◆ Near Rail and Airport ◆ Public places ◆ Forest and river ◆ Mighty wind

Ready To Fly

How to control the drone Ready to fly / Fly Drone

Power on => Pairing

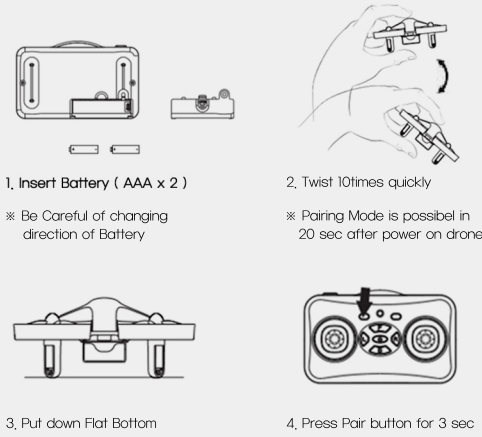

1. Insert Battery (AAA x 2)

※ Be Careful of changing direction of Battery

2. Twist 10times quickly

※ Pairing Mode is possible in 20 sec after power on drone

3. Put down Flat Bottom

4. Press Pair button for 3 sec

※ Need to Pair 1 times for the first time

Fly Drone (Basic)

Take Off => Fly Drone => Landing

1. Take Off

Press start/stop button for 3 Seconds



2. Fly Drone



Go Up !
Go Down !

Go Forward !
Go Backward !
Go Left shift !
Go Right shift !

Turn Left !
Turn Right !

3. Landing



Fly Drone (Trim & Flip)

Trim / 360 degree rotation

◆ Trim Drone

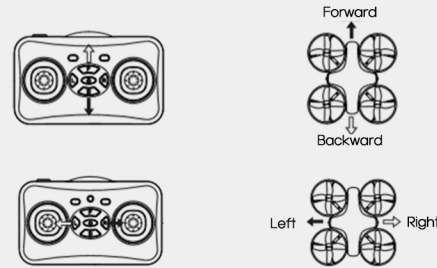

◆ 360 Rotation

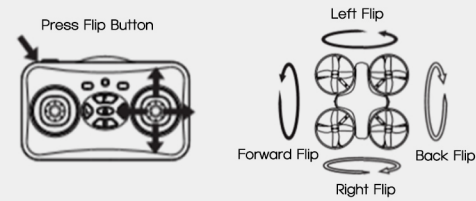

Fly Drone (Motor & Stop)

Motor on-off / Emergency Stop

◆ Motor On / Off



◆ Emergency Stop

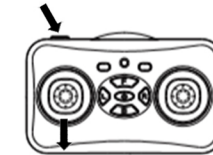

1. Press the speed/flip button.

2. Keep the button pressed and lower the lever.

Mode & Sensor Reset

Headless mode / Sensor Reset

◆ Headless

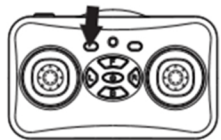

- Normal Mode
"Drone criterion"

- Headless Mode
"Pilot criterion"

◆ Sensor Reset



Initialize the sensors in the drones.

Charging & Replacement

Charging / Propeller replacement

◆ Charging

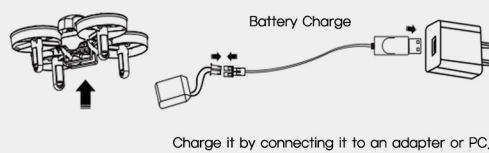

Charge it by connecting it to an adapter or PC.

◆ Replace Propeller

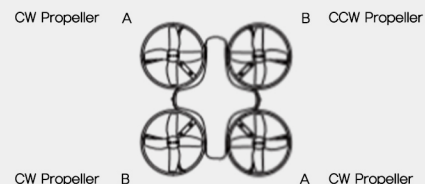

※ If the propeller orientation is incorrect, flight is not possible

Problem solving

Problem Solving Initial Defect and Warranty

◆ After connecting the battery to the drone, it just flashes.

- Cause : Pairing is broken.
- Solution : Please refer to the manual and try pairing again.

◆ Connecting a battery to the drone will not respond.

- Cause : We don't have enough battery.
- Solution : Charge the battery, please.

◆ The motor will not stop when the lever is lowered to land.

- Cause : The drone did not recognize the floor.
- Solution : Please try again to make the correct landing.

◆ The drone is not taking off.

- Cause :
 1. Please check the direction of the propeller.
 2. Please check the battery charge.
 3. Please try resetting the sensor.

- Solution :
 1. Check the Replace Propeller on the manual.
 2. Check the setting of the manual.
 3. Check the Sensor Reset on the manual.

Initial Defect and Warranty

Supports the following initial volume and warranty exchange policies.

1. Within 7 days of receipt of the new product
2. If the product has a flight time of less than 10 minutes

If a problem occurs with all of the above conditions, it is deemed 'initial poor' and the product can be exchanged.

Repair costs will be incurred for damages caused by user error other than 'initial defect' and other product repair and support should be contacted by the supplier.

- Drone simulator, Rocketsbrick for codon support scheduled

- Please check your homepage for coding manuals later on (roboLink.co.kr)